



For Sale



420 NE Kelly Street Gresham

\$299,000.00

- ◆ 960 SF Commercial office space; 240 SF garage
- ◆ Two private offices, open front reception/work area
- ◆ Kitchenette with washer dryer hook-up
- ◆ Newer Gas furnace and AC
- ◆ Good on-street parking & space for parking at back of building
- ◆ NE Kelly is a main north/south transit corridor
- ◆ One block North of Center for the Arts Plaza
- ◆ Located in Historic Downtown Gresham close to restaurants, parks, art plaza, farmers market and public transportation
- ◆ 2018-2019 Taxes \$1274.34

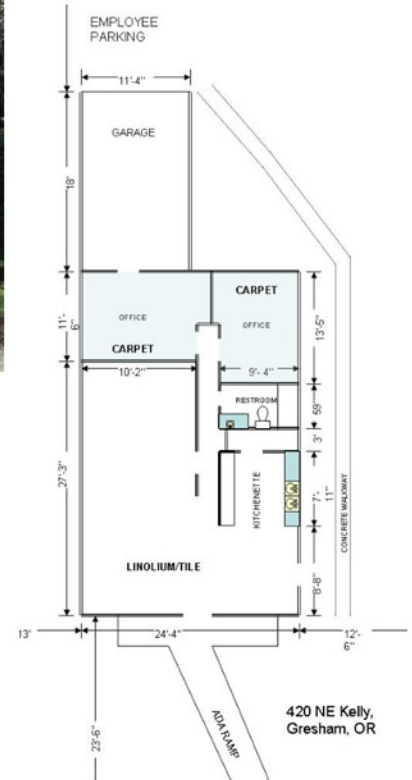

Contact: **Martin Stone, Broker, CCIM**

503-661-8000

www.KMOrealestate.com

Email: Martin@kmorealestate.com

